

#	DESCRIPTION	PART NUMBER	QTY
1	Collettore #1 / Down pipe #1	9773K059SDRXA	1
2	Collettore #2 / Down pipe #2	9773K059SDRXB	1
3	Tubo di raccordo 2-1 / Link pipe 2-1	9773K057S2C	1
4	Tubo di raccordo / Link pipe	9773K059SDRXD	1
5	Silenziatore / Muffler L.360 db killer 50.DK.021.0	OVAL CARBON CAP	1
6	Molla corta / Short Spring	50.73.123.1	2
7	Molla lunga / Long spring	50.71.080.1	2
8	Molla ultracorta / Ultra-short spring	50.73.951.1	1
9	Tubo in gomma per molla / Rubber pipe for spring	50.73.210.1	2
10	dB Killer	50.DK.082.0	1
11	Vite M8x25 / Screw M8x25	50.73.064.1	1
12	Rondella in alluminio / Aluminium washer	50.73.063.1	1
13	Staffa / Bracket	50.55.810.0	1
14	Dado M8 flangiato / Flanged nut M8	50.73.393.1	2
15	Rondella in alluminio nera / Black aluminium washer	50.73.221.1	1
16	Vite M8x45 / Screw M8x45	50.73.602.1	1
17	Protezione in gomma per staffa / Rubber protection for bracket	50.73.077.1	1
18	Staffa / Bracket	50.55.030.0	1

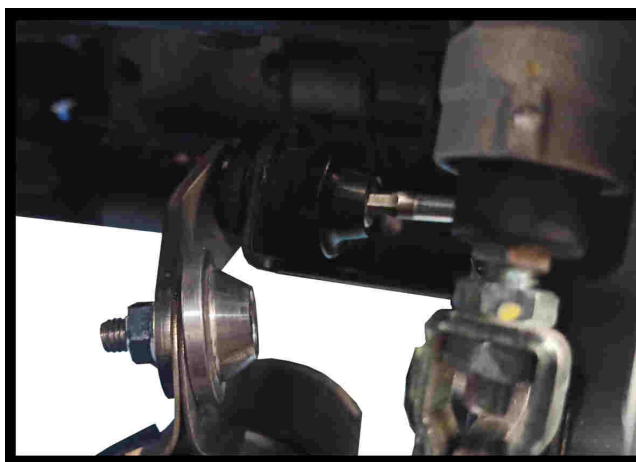

Mandatory Catalytic Converter
Cod. ACC.077.A1

Optional in K.059.LZC
Included in K.059.KZC

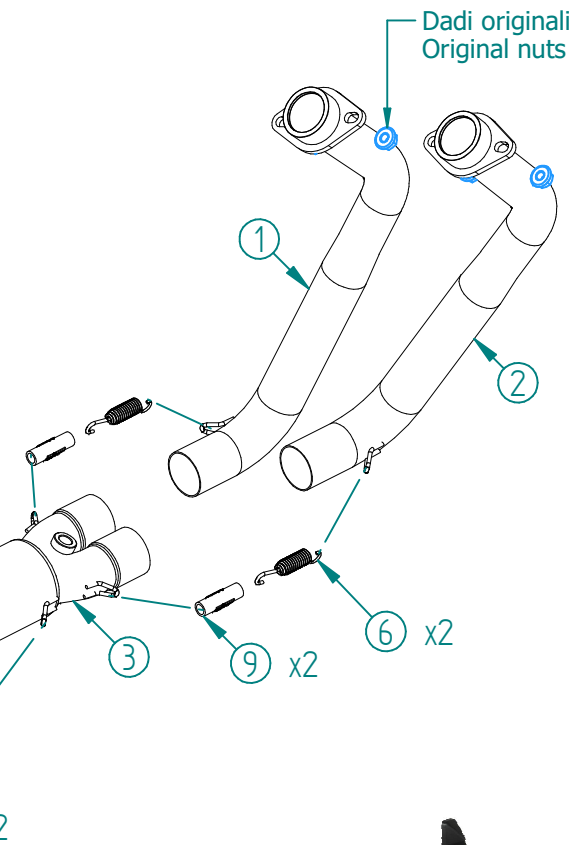

OPTIONAL PART

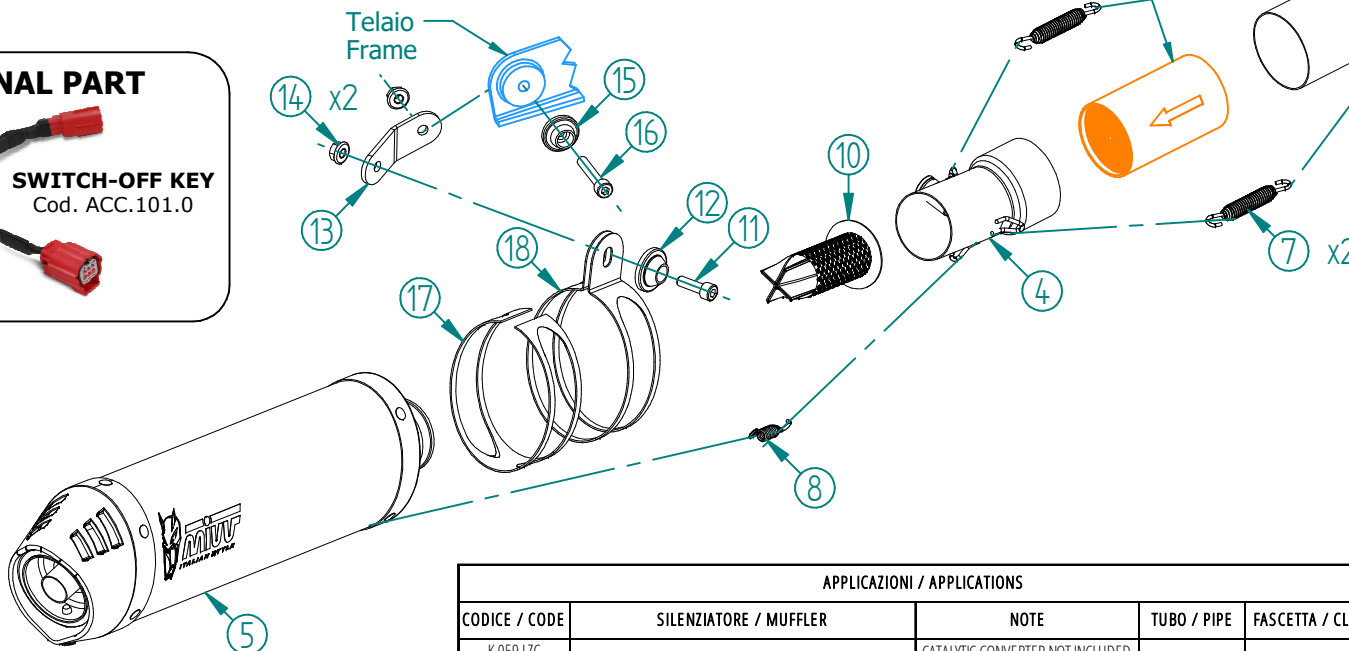

APPLICAZIONI / APPLICATIONS				
CODICE / CODE	SILENZIATORE / MUFFLER	NOTE	TUBO / PIPE	FASCETTA / CLAMP
K.059.LZC	INOX NERO (Coppa carbonio) / STEEL BLACK (Carbon cap)	CATALYTIC CONVERTER NOT INCLUDED	INOX / ST. STEEL	INOX / ST. STEEL
K.059.KZC		CATALYTIC CONVERTER INCLUDED		

