

Mandatory Catalytic Converter
Cod. ACC.087.A2

Optional in M.014.LH1BA
Included in M.014.KH1BA

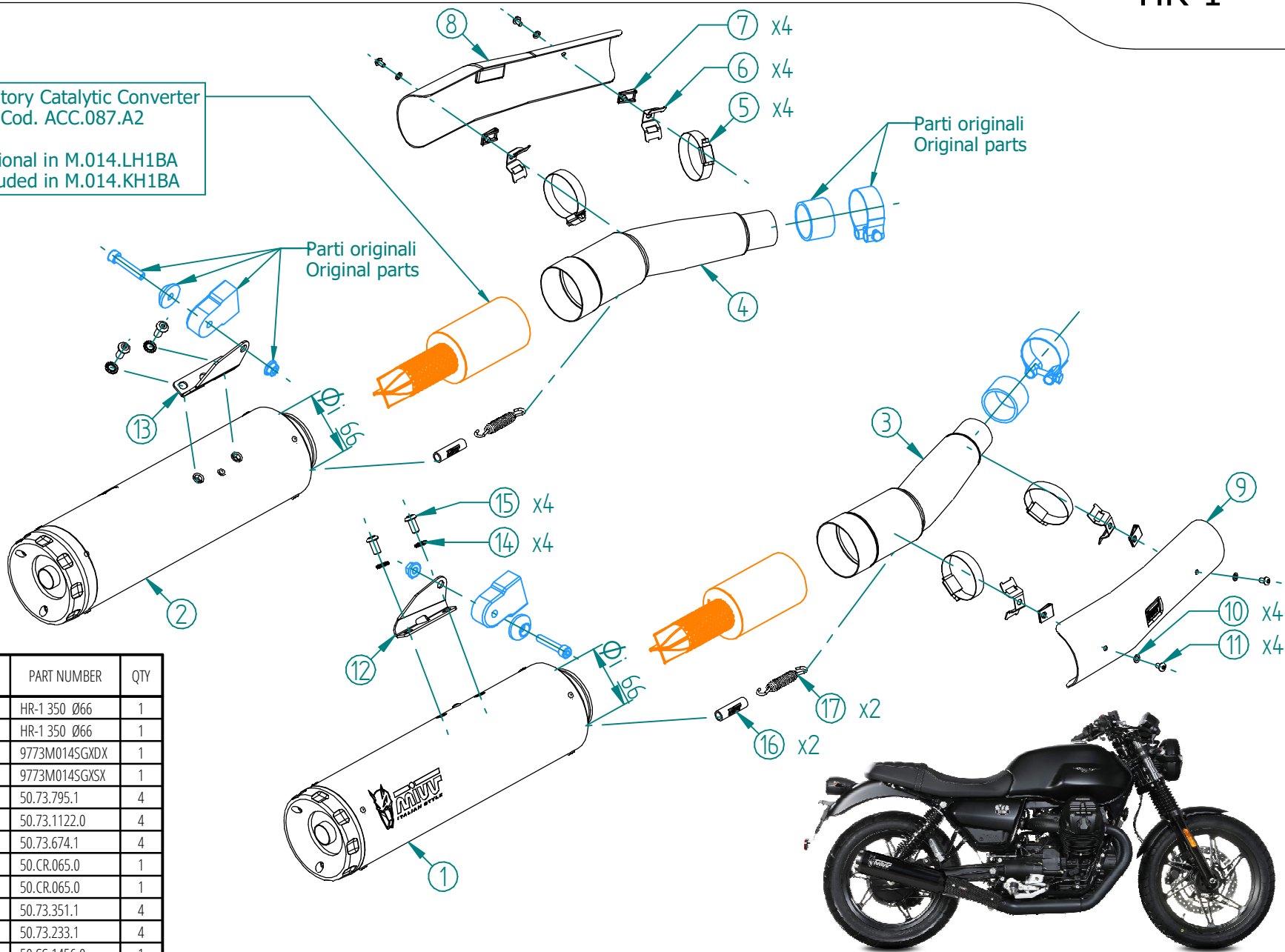

#	DESCRIPTION	PART NUMBER	QTY
1	Silenziatore destro / Right muffler - db killer 50.DK.194.0	HR-1 350 Ø66	1
2	Silenziatore sinistro / Left muffler - db killer 50.DK.194.0	HR-1 350 Ø66	1
3	Tubo di raccordo destro / Right link pipe	9773M014SGDX	1
4	Tubo di raccordo sinistro / Left link pipe	9773M014GSXS	1
5	Fascetta / Clamp	50.73.795.1	4
6	Staffa / Bracket	50.73.1122.0	4
7	Dado rapido M5 / M5 cage nut	50.73.674.1	4
8	Cover in carbonio sinistra / Left carbon cover	50.CR.065.0	1
9	Cover in carbonio destra / Right carbon cover	50.CR.065.0	1
10	Rondella M5 / Washer M5	50.73.351.1	4
11	Vite M5 x 8 / Screw M5 x 8	50.73.233.1	4
12	Staffa destra / Right bracket	50.SS.1456.0	1
13	Staffa sinistra / Left bracket	50.SS.1457.0	1
14	Rondella di sicurezza / Safety washer	50.73.604.1	4
15	Vite M8 x 16 / Screw M8 x 16	50.73.098.1	4
16	Tubo in gomma per molla / Rubber pipe for spring	50.73.210.1	2
17	Molla media / Mid-size spring	50.73.359.1	2

APPLICAZIONI / APPLICATIONS			
CODICE / CODE	SILENZIATORE / MUFFLER	TUBO / PIPE	NOTE
M.014.LH1BA	INOX NERO (COPPA ALLUMINIO) / STEEL BLACK (ALUMINIUM CAP)	INOX / ST. STEEL	CATALYTIC CONVERTER NOT INCLUDED
M.014.KH1BA			CATALYTIC CONVERTER INCLUDED