

### OPTIONAL PARTS

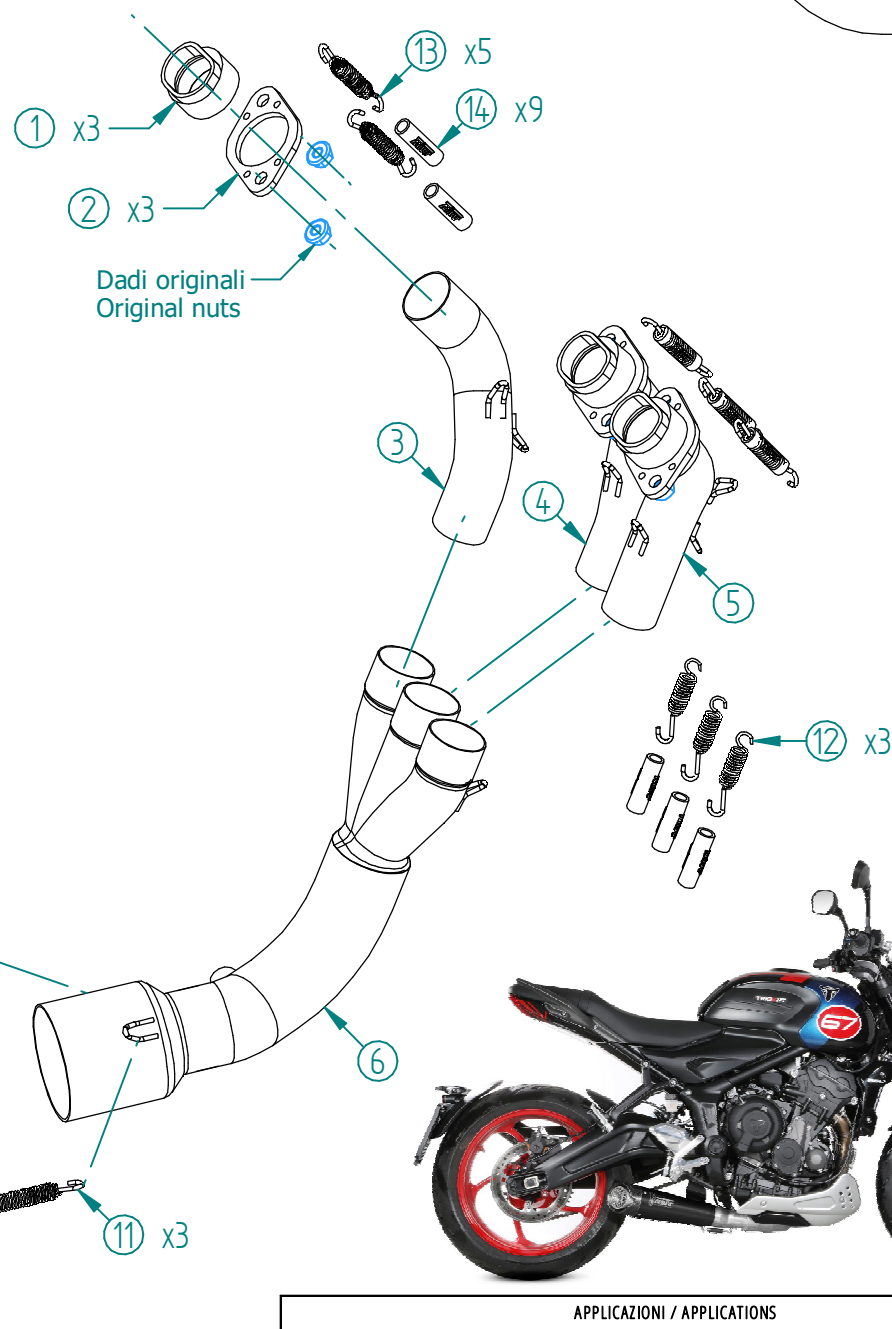

#	DESCRIPTION	PART NUMBER	QTY
1	Boccola / Bush	50.73.968.1	3
2	Flangia / Flange	50.73.969.1	3
3	Collettore #1 / Down pipe #1	9773T029SDRXA	1
4	Collettore #2 / Down pipe #2	9773T029SDRXB	1
5	Collettore #3 / Down pipe #3	9773T029SDRXC	1
6	Tubo di raccordo 3-1 / Link pipe 3-1	9773T029SDRXD	1
7	Tubo di raccordo / Link pipe	9773T029SDRXE	1
8	Silenziatore / Muffler - dB killer 50.DK.150.0	X-M5 Ø165	1
9	Rondella in alluminio nera / Black aluminium washer	50.73.221.1	1
10	Vite M8x20 / Screw M8x20	50.73.894.1	1
11	Molla lunga / Long spring	50.71.080.1	3
12	Molla corta / Short Spring	50.73.123.1	3
13	Molla media / Mid-size spring	50.73.359.1	5
14	Tubo in gomma per molla / Rubber pipe for spring	50.73.210.1	9



APPLICAZIONI / APPLICATIONS		
CODICE / CODE	SILENZIATORE / MUFFLER	TUBO / PIPE
T.029.SC5B	STEEL BLACK	INOX / ST. STEEL