

#	DESCRIPTION	PART NUMBER	QTY
1	Tubo collettore / Down pipe	9773Y067S2A	1
2	Tubo di raccordo / Link pipe	9773Y067S2B	1
3	Protezione in gomma per staffa / Rubber protection	50.73.040.1	1
4	Staffa / Bracket	50.55.001.0	1
5	Vite M8x20 / Screw M8x20	50.73.894.1	1
6	Rondella in alluminio / Aluminium washer	50.73.063.1	1
7	Staffa / Bracket	50.55.1490.0	1
8	Dado M8 flangiato / Flanged nut M8	50.73.393.1	2
9	Vite M8x45 / Screw M8x45	50.73.602.1	1
10	Rondella in alluminio / Aluminium washer	50.73.291.1	1
11	Boccola / Bush	50.73.1078.1	2
12	Silenziatore / Muffler - dB killer 50.DK.021.0	GP	1
13	Tubo in gomma per molla / Rubber pipe for spring	50.73.210.1	3
14	Molla media / Mid-size spring	50.73.359.1	3
15	Tappo sonda lambda / Lambda probe stopper	50.73.111.1	1

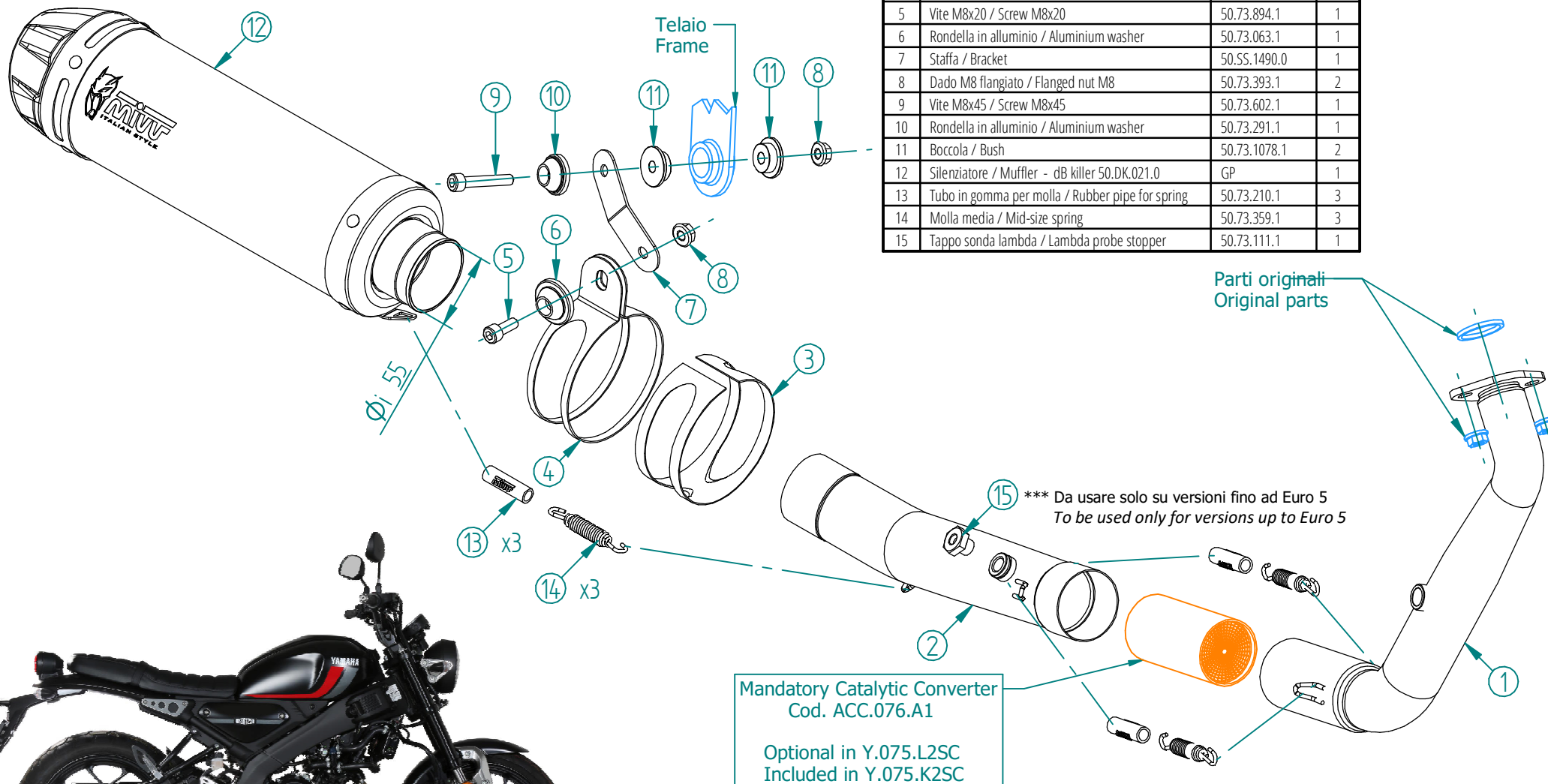

**Mandatory Catalytic Converter**  
Cod. ACC.076.A1

Optional in Y.075.L2SC  
Included in Y.075.K2SC

APPLICAZIONI / APPLICATIONS				
CODICE / CODE	SILENZIATORE / MUFFLER	NOTE	FASCETTA / CLAMP	TUBO / PIPE
Y.075.L2SC	CARBONIO ( coppa carbonio ) / CARBON FIBER ( carbon cap )	CATALYTIC CONVERTER NOT INCLUDED	INOX / ST. STEEL	INOX / ST. STEEL
Y.075.K2SC		CATALYTIC CONVERTER INCLUDED		