

#	DESCRIPTION	PART NUMBER	QTY
1	Collettore #1 / Down pipe #1	9773H096C1A	1
2	Collettore #2 / Down pipe #2	9773H096C1B	1
3	Collettore #3 / Down pipe #3	9773H096C1C	1
4	Collettore #4 / Down pipe #4	9773H096C1D	1
5	Tubo di raccordo 2-1 / Link pipe 2-1	9773H096C1E	1
6	Tubo di raccordo 2-1 / Link pipe 2-1	9773H096C1F	1
7	Tubo di raccordo 2-1 / Link pipe 2-1	9773H096C1G	1
8	Tubo di raccordo / Link pipe	9773H096C1H	1
9	Silenziatore / Muffler - dB killer 50.DK.150.0	GP PRO 220	1
10	Vite M8x20 / Screw M8x20	50.73.894.1	1
11	Rondella in alluminio nera / Black aluminium washer	50.73.221.1	2
12	Staffa / Bracket	50.SS.1549.0	1
13	Rondella di sicurezza / Safety washer	50.73.604.1	2
14	Vite M8 x 16 / Screw M8 x 16	50.73.098.1	2
15	Dado M8 autobloccante / M8 locknut	50.73.1101.1	1
16	Staffa / Bracket	50.SS.1614.0	1
17	Dado M8 flangiato / Flanged nut M8	50.73.393.1	2
18	Vite M8x50 / Screw M8x50	50.73.088.1	1
19	Vite M5 x 8 / Screw M5 x 8	50.73.233.1	2
20	Rondella M5 / Washer M5	50.73.351.1	2
21	Cover in carbonio / Carbon cover	50.CR.070.0	1
22	Dado rapido M5 / M5 cage nut	50.73.674.1	2
23	Staffa / Bracket	50.73.1122.0	2
24	Fascetta / Clamp	50.73.795.1	2
25	Vite M8x50 / Screw M8x50	50.73.074.1	1
26	Tubo in gomma per molla / Rubber pipe for spring	50.73.210.1	7
27	Molla media / Mid-size spring	50.73.359.1	5
28	Molla lunga / Long spring	50.71.080.1	4

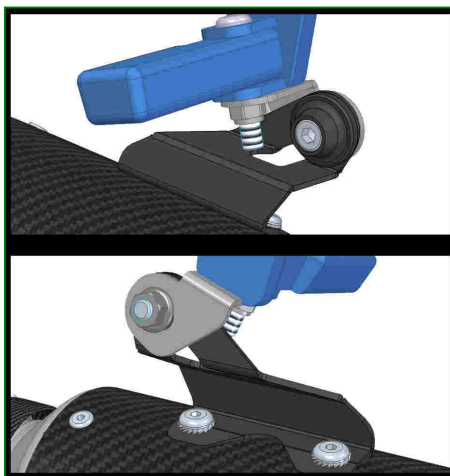

Guarnizioni e dadi originali
Original gaskets and nuts

Parti originali
Original parts

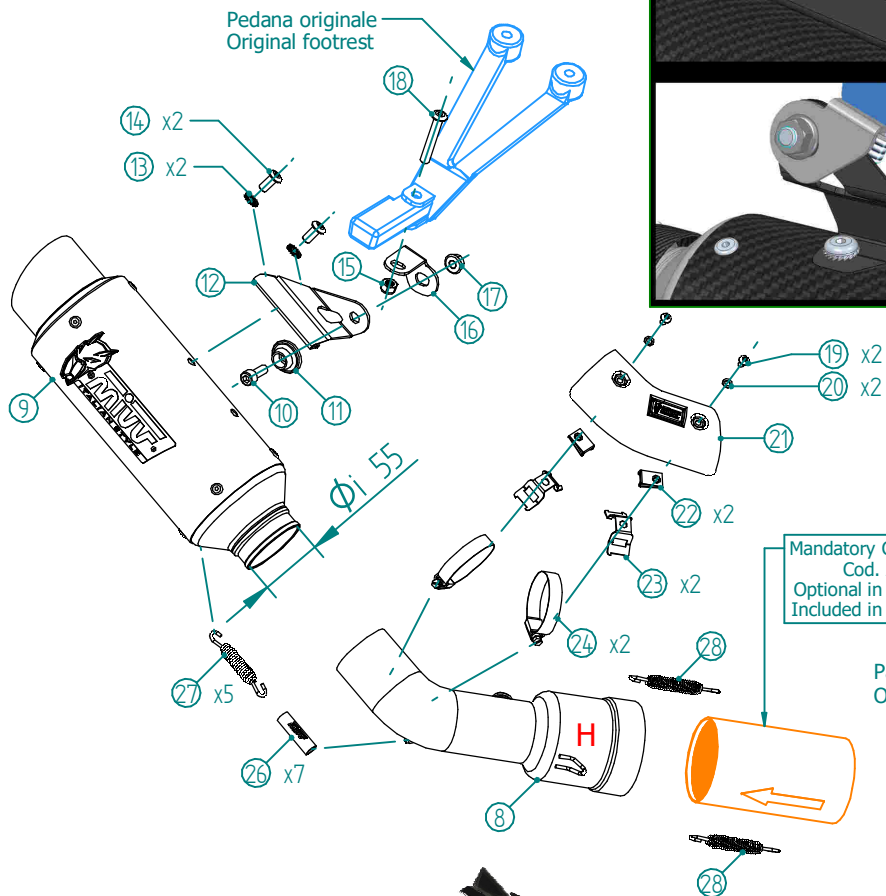
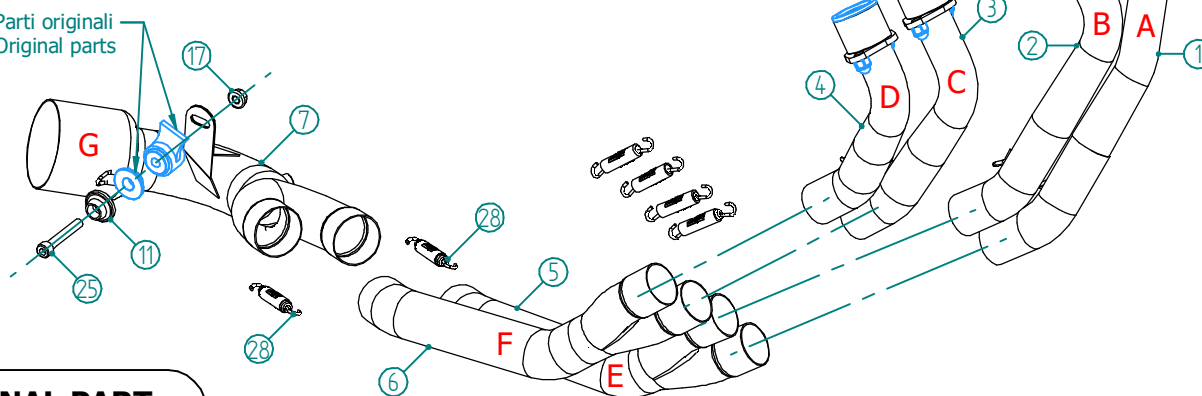

OPTIONAL PART



SWITCH-OFF KEY
Cod. ACC.101.0

APPLICAZIONI / APPLICATIONS				
CODICE / CODE	SILENZIATORE / MUFFLER	LOGO	TUBO / PIPE	NOTE
H.096.L2P	CARBONIO / CARBON FIBER	ALUMINIUM LABEL	INOX / ST. STEEL	CATALYTIC CONVERTER NOT INCLUDED
H.096.K2P				CATALYTIC CONVERTER INCLUDED
H.096.LXBP	STEEL BLACK	LASER		CATALYTIC CONVERTER NOT INCLUDED
H.096.KXBP				CATALYTIC CONVERTER INCLUDED